

# DD-28 SILVER ET2 SILVER dryers



## EASY TOUCH 2

User friendly and totally programmable 7" ET2  
USB Connection.  
Online platform free of charge for programming, telemetry, data analysis  
Videos on display (ads, instructions, etc.)  
37 languages



## FEATURES

Reversing drum action as standard  
Stainless steel drum as standard  
Frequency inverter as standard



## EFFICIENCY

**DOUBLE FLOW** - mixed axial-radial airflow  
Big fluff filter as drawer



## VERSATILITY

Make to order - customisation  
**WET CLEANING**  
OPL > Multivending - Standard OPL model easily trasformable to coin laundry uses



## CONNECTIVITY

**Danube Online communication - IoT as standard**  
Remote technical service  
Management of laundries: OPL and COIN



## ERGONOMICS

Drawer as fluff filter, stainless steel mesh  
Big door diameters  
Opening sense of door adjustable on site



## MAINTENANCE

Hinged control panel: easy and ergonomic access  
Technical menu: statistics, data recovery for after-sales service, software updates, etc.  
Easy access to components



## OTHERS

Grey skinplate outer casing, stainless steel look  
**NEW:** transmission by gear motor on models DD-45 to 80  
**SOFT DRY** - new drum with stamped holes  
**COOL DOWN** - anti-wrinkle at the end of the cycle  
Electric, gas or steam heating  
CE approved



## OPTIONS

- IoT licence - Danube Online
- NG Natural gas heated tumble dryer (LPG as standard)
- IMC CARE DRY Humidity sensor
- DG Double doorglass DD-11-28
- FEX Sprinkler fire extinguisher 22,28
- RD Opposite door opening 11-35
- TR Tropicalized model (ET2)
- DS Perfumes dosing / spraying
- AF Back panel with air filter from 11 to 35
- F06 Fluff filter with grid 0,6mm (standard is 0,3mm)
- F12 Fluff filter with grid 1,2 mm (standard is 0,3 mm)
- SSC Stainless steel outer casing 28
- SSF Stainless steel front panel 28, 35
- BSS Stainless steel steam battery 28-35
- LPB Low steam pressure battery 28,35
- WB Wooden packing 28
- 400V 3N 60 Hz DD-11-35
- 230V 3~ 50 Hz DD-22-35 E
- 230V 3~ 60 Hz DD-22,35 E
- 230V 3~ 60 Hz DD-11,35 G/S
- 440/480V 3~ 60 Hz DD-22-35
- Several payment systems for self-service

CAPACITY & DRUM		UNIT.	DD-28 SILVER ET2
Capacity 1/18		Kg	30,6
		lb	67,3
Capacity 1/20		Kg	27,5
		lb	60,6
Ø Drum		mm	947
		inch	37,28
Drum length		mm	780
		inch	30,71
Drum volume		l	550
		cu ft	19,42
Ø Door hole		mm	802
		inch	31,57
Door center height		mm	1.040
		inch	40,94
Height from floor to bottom of door		mm	578
		inch	22,74
ELECTRIC HEATING			
Evaporation capacity		L/h	26,1
		US gallon/h	6,9
Hourly output		Kg/h	48,4
		lb/h	106,7
Installed heating power		kW	30
Installed electrical power		kW	31,15
Drum motor power		kW	0,55
GAS HEATING			
Evaporation capacity (gas model)		L/h	30,9
		US gallon/h	8,163
Hourly output (gas model)		Kg/h	59,3
		lb/h	130,7
Installed gas heating power		kcal/h	35276
		Btu/h	139986,5
Installed gas heating power		kW	41
Installed electrical power		kW	1,15
Instant propane gas consumption (G31)		Kg/h	3,51
		lb/h	7,74
Instant natural gas consumption (G20)		m <sup>3</sup> /h	4,34
		cfm	2,55
Ø Gas inlet		BSPP ISO 228-1	1/2"
STEAM HEATING			
Installed steam heating power		kW	50,10
		Btu/h	170948
Installed electrical power		kW	1,15
Steam consumption (8 barG) - Standard		kg/h	89
Steam consumption (116 psiG)		lb/h	107,2
Steam pressure		barG	6 - 9
		psiG	87 - 130,5
Standard steam inlet - outlet		BSPT- ISO7.1	1"
Steam inlet - condensate outlet		NPT ANSI B1.20.1 Tapered	1"
Steam consumption (5 barG) - Low Pressure		kg/h	93
Steam consumption (72,5 psiG) - Low Pressure		lb/h	112
Steam pressure (low pressure)		barG	3 - 6
		psiG	43,5 - 95
Low pressure steam inlet - outlet		BSPT- ISO7.1	1" 1/2
VENTILATION			
Fan motor power		kW	0,55
Nominal air flow rate		m <sup>3</sup> /h	1.200
		cfm	706,29



Ø Fume exhaust	mm	200	
	inch	7,87	
<b>HEAT EMISSION</b>			
Maximum total heat emission	kW	3	
	Btu/h	10242,4	
Max. front heat emission	kW	2,1	
	Btu/h	7169,7	
<b>CONNECTIONS</b>			
Tension 230V - I + N + T	Nº x mm² / A	E	G / S
Tension 230V - III + T	Nº x mm² / A	4 x 35 / 100A	3 x 1,5 / 16A
Tension 400V - III + N + T	Nº x mm² / A	5 x 16 / 63A	3 x 1,5 / 16A
<b>NET DIMENSIONS / PACKING DIMENSIONS</b>			
Net / gross width	mm	985 / 1.065	
	inch	38,78 / 41,93	
Net / gross depth	mm	1.054 / 1.154	
	inch	41,50 / 45,43	
Net height / gross height (* without heating)	mm	1.975 / 2.080	
	inch	77,76 / 81,89	
Net / gross weight	Kg	230 / 260	
	lb	507,06 / 573,20	
<b>OTHERS</b>			
Sound level	dB	65	

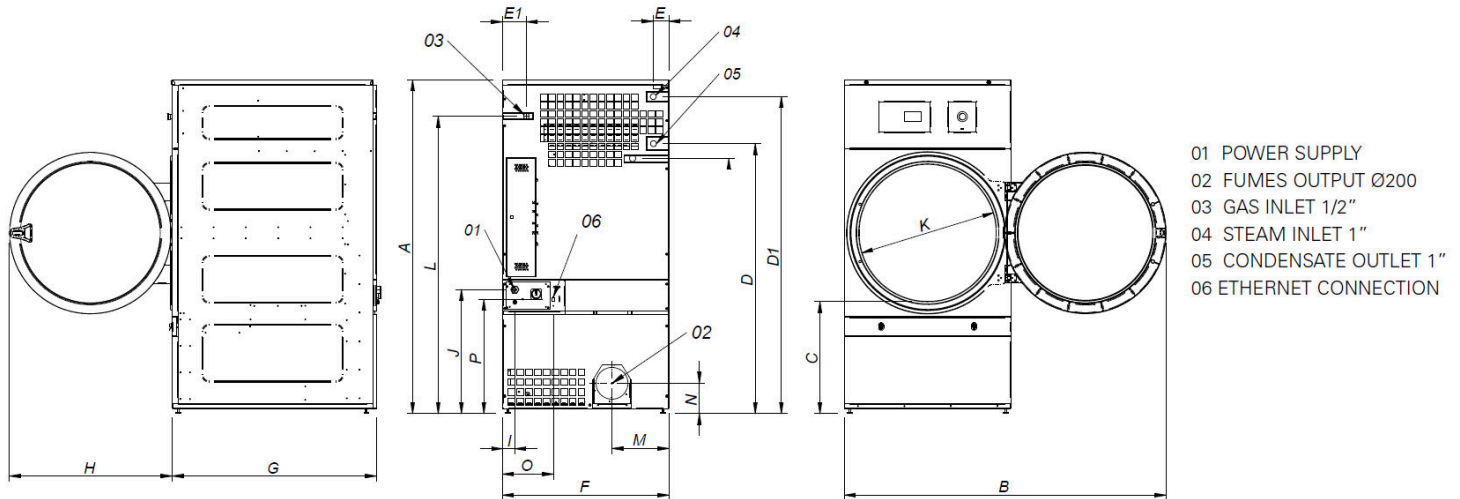

	A	B	C	D	D1	E	E1	F	G	H	I	J	K	L	M	N	O	P
DD-28	1975*	1910	660	1590	1875	102	130	985	1054	970	70	730	802	1760	337	178	301	676
DD-35	1975*	1910	660	1590	1875	102	130	985	1210	970	70	730	802	1760	337	178	301	676

\* Measurement with legs mounted (30mm)

