

DD-18 BRONZE EM BRONZE dryers



ELECTRONIC CONTROL

Easy-to-use electronic control with push buttons to control temperature and time



FEATURES

Reversing drum action as standard
Stainless steel drum as standard
Frequency inverter as standard



EFFICIENCY

DOUBLE FLOW - mixed axial-radial airflow
Big fluff filter as drawer



VERSATILITY

Make to order - customisation
OPL > Multivending - Standard OPL model easily trasformable to coin laundry uses



ERGONOMICS

Drawer as fluff filter, stainless steel mesh
Big door diameters
Opening sense of door adjustable on site



MAINTENANCE

Hinged control panel: easy and ergonomic access
Technical menu: statistics, data recovery for after-sales service, software updates, etc.
Easy access to components



OTHERS

Grey skinplate outer casing, stainless steel look
NEW: transmission by gear motor on models DD-45 to 80
SOFT DRY - new drum with stamped holes
COOL DOWN - anti-wrinkle at the end of the cycle
Electric, gas or steam heating
CE approved



OPTIONS

- DG Double doorglass DD-11-28
- NG Natural gas heated tumble dryer (LPG as standard)
- RD Opposite door opening 11-35
- BMS New display for EM programmer 11-35
- AF Back panel with air filter from 11 to 35
- F06 Fluff filter with grid 0,6mm (standard is 0,3mm)
- F12 Fluff filter with grid 1,2 mm (standard is 0,3 mm)
- RP Reduced power (12kw instead of 18kw) for electric heated 14kg and 18kg models.
- SSC Stainless steel outer casing (AISI-304) 14, 18
- SSF Stainless steel front panel (AISI-304) 11, 14, 18
- BSS Stainless steel steam battery 11-14-18
- WB Wooden packing 14,18
- 400V 3N 60 Hz DD--11-35
- 230V 3~ 50 Hz DD-11, 14, 18 E
- 230V 3~ 60 Hz DD-11,14, 18 E
- 230V 3~ 60 Hz DD-11,35 G/S
- 440/480V 3~ 60 Hz DD- 11,18
- Several payment systems for self-service

| CAPACITY & DRUM | | UNIT. | DD-18 BRONZE EM |
|--|--|--------------------------|-----------------|
| Capacity 1/18 | | Kg | 18,3 |
| | | lb | 40,4 |
| Capacity 1/20 | | Kg | 16,5 |
| | | lb | 36,3 |
| Ø Drum | | mm | 750 |
| | | inch | 29,5 |
| Drum length | | mm | 746 |
| | | inch | 29,4 |
| Drum volume | | l | 330 |
| | | cu ft | 11,64 |
| Ø Door hole | | mm | 574 |
| | | inch | 22,6 |
| Door center height | | mm | 976 |
| | | inch | 38,4 |
| Height from floor to bottom of door | | mm | 618 |
| | | inch | 24,33 |
| ELECTRIC HEATING | | | |
| Evaporation capacity | | L/h | 14,1 |
| | | US gallon/h | 3,72 |
| Hourly output | | Kg/h | 28,3 |
| | | lb/h | 62,39 |
| Installed heating power | | kW | 18 |
| Installed electrical power | | kW | 18,67 |
| Drum motor power | | kW | 0,37 |
| GAS HEATING | | | |
| Evaporation capacity (gas model) | | L/h | 16,30 |
| | | US gallon/h | 4,31 |
| Hourly output (gas model) | | Kg/h | 31,90 |
| | | lb/h | 70,33 |
| Installed gas heating power | | kcal/h | 17727 |
| | | Btu/h | 69996 |
| Installed gas heating power | | kW | 20,5 |
| Installed electrical power | | kW | 0,67 |
| Instant propane gas consumption (G31) | | Kg/h | 1,76 |
| | | lb/h | 3,88 |
| Instant natural gas consumption (G20) | | m ³ /h | 2,17 |
| | | cfm | 1,28 |
| Ø Gas inlet | | BSPP ISO 228-1 | 1/2" |
| STEAM HEATING | | | |
| Installed steam heating power | | kW | 30 |
| | | Btu/h | 102364 |
| Installed electrical power | | kW | 0,67 |
| Steam consumption (8 barG) - Standard | | kg/h | 53 |
| Steam consumption (116 psiG) | | lb/h | 63,8 |
| Steam pressure | | barG | 6 - 9 |
| | | psiG | 87 - 130,5 |
| Standard steam inlet - outlet | | BSPT- ISO7.1 | 3/4" |
| Steam inlet - condensate outlet | | NPT ANSI B1.20.1 Tapered | 3/4" |
| Steam consumption (5 barG) - Low Pressure | | kg/h | 57 |
| Steam consumption (72,5 psiG) - Low Pressure | | lb/h | 68,7 |
| Steam pressure (low pressure) | | barG | 3 - 6 |
| | | psiG | 43,5 - 91 |
| Low pressure steam inlet - outlet | | BSPT- ISO7.1 | 1" |
| VENTILATION | | | |
| Fan motor power | | kW | 0,25 |
| Nominal air flow rate | | m ³ /h | 850 |
| | | cfm | 500 |



| | | | |
|---|--------------|---------------|---------------|
| Ø Fume exhaust | mm | 200 | |
| | inch | 7,87 | |
| HEAT EMISSION | | | |
| Maximum total heat emission | kW | 1,8 | |
| | Btu/h | 6145 | |
| Max. front heat emission | kW | 1,3 | |
| | Btu/h | 4302 | |
| CONNECTIONS | | | |
| Tension 230V - I + N + T | Nº x mm² / A | E | G / S |
| Tension 230V - III + T | Nº x mm² / A | 4 x 16 / 63A | 3 x 1,5 / 16A |
| Tension 400V - III + N + T | Nº x mm² / A | 5 x 10 / 32A | 3 x 1,5 / 16A |
| NET DIMENSIONS / PACKING DIMENSIONS | | | |
| Net / gross width | mm | 785 / 865 | |
| | inch | 30,9 / 34,1 | |
| Net / gross depth | mm | 1.125 / 1.210 | |
| | inch | 44,3 / 47,6 | |
| Net height / gross height (* without heating) | mm | 1.694 / 1.840 | |
| | inch | 66,7 / 72,4 | |
| Net / gross weight | Kg | 187 / 200 | |
| | lb | 412 / 441 | |
| OTHERS | | | |
| Sound level | dB | 64 | |

* Sizes Gas or steam 45 kg model same as model 80 kg (incorporates the batteries at the back)

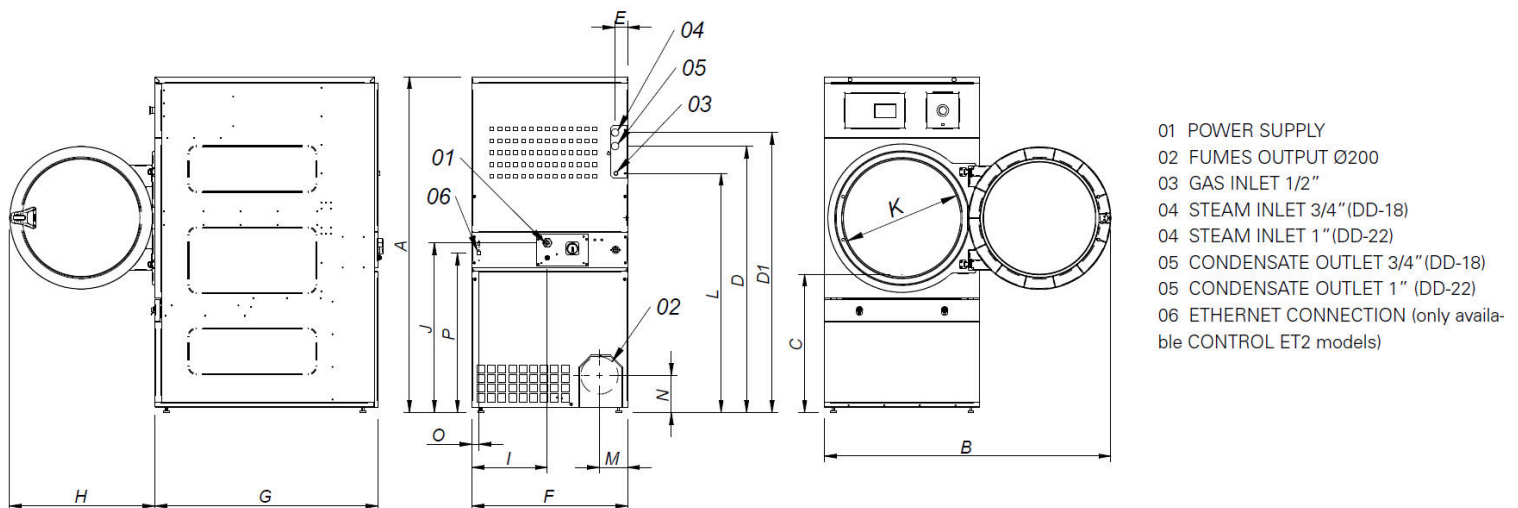

| | A | B | C | D | D1 | E | E1 | F | G | H | I | J | K | L | M | N | O | P |
|-------|-------|------|-----|------|------|-----|----|-----|------|-----|-----|-----|-----|------|-----|-----|----|-----|
| DD-18 | 1694* | 1447 | 689 | 1354 | 1422 | 68 | 68 | 785 | 855 | 735 | 380 | 870 | 575 | 1226 | 133 | 180 | 35 | 805 |
| DD-22 | 1812* | 1552 | 743 | 1430 | 1532 | 112 | 55 | 890 | 1255 | 735 | 107 | 920 | 575 | 1344 | 238 | 180 | 37 | 860 |

* Measurement with legs mounted (30mm)

