



DPR-8 ET2

ET2 professional dryers



EASY TOUCH 2

User friendly and totally programmable 4,3"
USB Connection. Online platform free of charge for programming, telemetry, data analysis...thanks to the IoT
Videos on display (ads, instructions, etc.)
37 languages
8 dosing signals as standard



VERSATILITY

OPL <> COIN
SINGLE <> STACKED
Models can be stacked on top of a washer or on another dryer.
Control panel can be assembled between both drums for better ergonomics.
Ideal for multiple solutions: hotels, campings, coin laundries, gyms, etc.
Ready to be used with WET CLEANING programs



FEATURES

Reduced drying times (less than 45 minutes)
6,75 kw heating, option 4,5 kw



CONNECTIVITY

IoT - Danube online standard.
Management of laundries: OPL and COIN
Remote payment



EFFICIENCY

Optimised airflow system
Axial airflow
Wide fluff filter as drawer
Efficient design



ROBUSTNESS

Outer casing in grey skinplate
Robust aluminium big door
Industrial fan and powerful airflow
Sturdy construction of the dryer structure and panels



OTHERS

Gas or electric heated models
Galvanized drum, grey skinplate panels
CE approved



OPTIONS

- Ergonomics plinth WPR-DPR - skinplate (except BASIC)
- Ergonomics plinth WPR-DPR -Stainless steel (except BASIC)
- NG Natural gas heated tumble dryer (LPG as standard)
- SSD Stainless steel drum AISI-304
- SSC Stainless steel outer casing DPR (Except BASIC)
- RD reverse door opening (Except BASIC)
- CU control panel in the bottom (except BASIC)
- TR Tropicalized model (ET2)
- IMC CARE DRY Humidity control (ET2)
- FEX Sprinkler fire extinguisher DPR (ET2)
- Supl. 400V III /230 I/III 60HZ DPR 8-10
- Ergonomic plinth WPR-DPR - skinplate
- Supl 440-480V III 50/60 Marine DPR 8-10
- Ergonomic plinth WPR-DPR - stainless steel
- IoT licence - Danube Online
- Several payment systems for self-service

CAPACITY & DRUM		UNIT.	DPR-8 ET2	
Capacity 1/18		Kg	8,9	
		lb	19,6	
Capacity 1/20		Kg	8	
		lb	17,6	
Ø Drum		mm	590	
		inch	23,2	
Drum length		mm	585	
		inch	23	
Drum volume		l	160	
		cu ft	5,65	
Ø Door hole		mm	480	
		inch	18,90	
Door center height		mm	554	
		inch	21,8	
Height from floor to bottom of door		mm	250	
		inch	9,84	
ELECTRIC HEATING				
Evaporation capacity		L/h	5,3	
		US gallon/h	1,40	
Hourly output		Kg/h	10,6	
		lb/h	23,37	
Installed heating power		kW	4,5 / 6,75	
Installed electrical power		kW	4,92 / 7,17	
Drum motor power*		kW	0,37	
GAS HEATING				
Evaporation capacity		L/h	5,3	
		US gallon/h	1,40	
Hourly output		Kg/h	10,6	
		lb/h	23,37	
Installed gas heating power		kcal/h	5761	
		Btu/h	22861	
Installed gas heating power		kW	6,70	
Installed electrical power		kW	0,42	
Instant propane gas consumption (G31)		Kg/h	0,57	
		lb/h	1,26	
Instant natural gas consumption (G20)		m ³ /h	0,71	
		cfm	0,42	
Ø Gas inlet		BSPP ISO 228-1	1/2"	
VENTILATION				
Fan motor power*		kW	0,37	
Nominal air flow rate		m ³ /h	300	
		cfm	177	
Ø Fume exhaust		mm	100	
		inch	3,94	
HEAT EMISSION				
Maximum total heat emission		kW	0,5	
		Btu/h	1536	
Max. front heat emission		kW	0,3	
		Btu/h	1075	
CONNECTIONS				
Tension 230V - I + N + T		Nº x mm ² / A	E 3 x 10 / 40A	G 3 x 1,5 / 10A
Tension 230V - III + T		Nº x mm ² / A	4 x 4 / 25A	3 x 1,5 / 10A (1)
Tension 400V - III + N + T		Nº x mm ² / A	5 x 2,5 / 16A	3 x 1,5 / 10A (2)
DIMENSIONS / PACKING DIMENSIONS				
Net / gross width		mm	680 / 710	
		inch	26,8 / 28	



Net / gross depth	mm	722 / 832
	inch	28,4 / 32,8
Net / gross height	mm	1.056 / 1.141
	inch	41,6 / 44,9
Net / gross weight	Kg	89 / 108
	lb	196 / 237
OTHERS		
Sound level	dB	62

*Single motor for drum and fan
(1) connect 2 phases and earth
(2) connect phase, neutral and earth

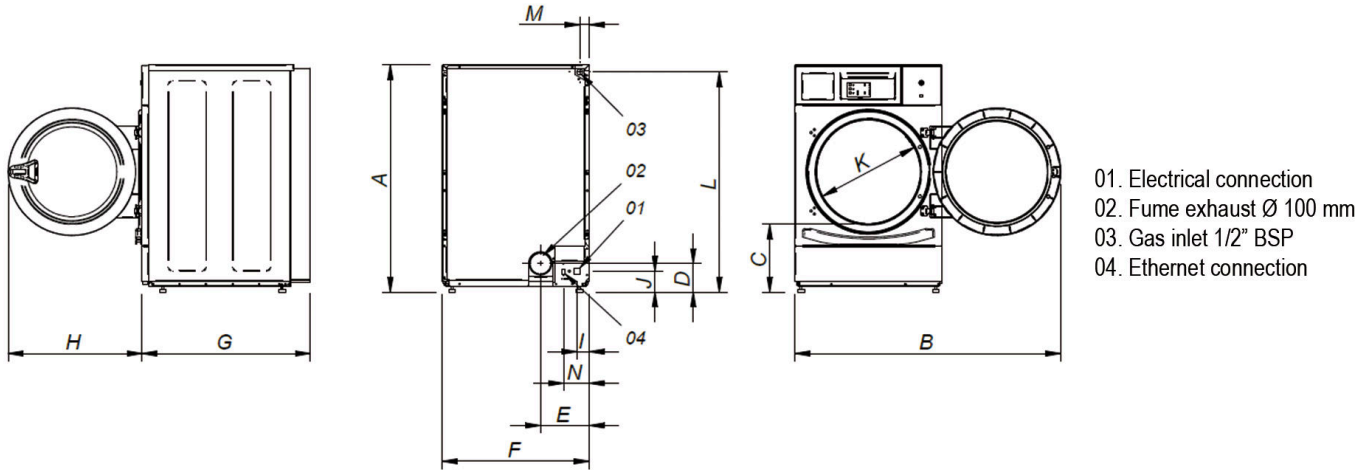

	A	B	C	D	E	F	G	H	I	J	K	L	M	N
DPR-8	1 056	1 227	320	140	226	680	775	615	57	91	480	1 015	50	118
DPR-10	1 056	1 227	320	140	226	680	775	615	57	91	480	1 015	50	118

