

DD-60 BRONZE EM BRONZE dryers



ELECTRONIC CONTROL

Easy-to-use electronic control with push buttons to control temperature and time



FEATURES

Reversing drum action as standard
Stainless steel drum as standard
Frequency inverter as standard



EFFICIENCY

DOUBLE FLOW - mixed axial-radial airflow
Big fluff filter as drawer



VERSATILITY

Make to order - customisation
OPL > Multivending - Standard OPL model easily trasformable to coin laundry uses



ERGONOMICS

Drawer as fluff filter, stainless steel mesh
Big door diameters
Opening sense of door adjustable on site



MAINTENANCE

Hinged control panel: easy and ergonomic access
Technical menu: statistics, data recovery for after-sales service, software updates, etc.
Easy access to components



OTHERS

Grey skinplate outer casing, stainless steel look
NEW: transmission by gear motor on models DD-45 to 80
SOFT DRY - new drum with stamped holes
COOL DOWN - anti-wrinkle at the end of the cycle
Electric, gas or steam heating
CE approved



OPTIONS

- GM Manual sliding door 45 to 80 models (without double door glass)
- DG Double doorglass DD-35-80
- NG Natural gas heated tumble dryer (LPG as standard)
- RD Opposite door opening 45-80
- BMS New display for EM programmer 11-35
- AF Back panel with air filter from 45 to 80
- F06 Fluff filter with grid 0,6mm (standard is 0,3mm)
- F12 Fluff filter with grid 1,2 mm (standard is 0,3 mm)
- SSC Stainless steel outer casing 60
- LPB Low steam pressure battery 45,60,80
- WB Wooden packing 60
- 400V 3N 60 Hz DD- 45-80 E/S
- 400V 3N 60 Hz DD45-80 G
- 230V 3~ 50 Hz DD-45-80 G
- 230V 3~ 60 Hz DD-45,80 S
- 230V 3~ 60 Hz DD-45,80 G
- 400V 3~ 50 Hz DD-60-80
- 440/480V 3~ 60 Hz DD-45-60-80

CAPACITY & DRUM	UNIT.	DD-60 BRONZE EM
Capacity 1/18	Kg	66,7
	lb	146,9
Capacity 1/20	Kg	60
	lb	132,3
Ø Drum	mm	1.225
	inch	48,2
Drum length	mm	1.020
	inch	40,2
Drum volume	l	1.200
	cu ft	42,37
Ø Door hole	mm	802
	inch	31,6
Door center height	mm	1.275
	inch	50,2
Height from floor to bottom of door	mm	813
	inch	31,99
ELECTRIC HEATING		
Evaporation capacity	L/h	60,2
	US gallon/h	19,90
Hourly output	Kg/h	120
	lb/h	264,55
Installed heating power	kW	72
Installed electrical power	kW	74,25
Drum motor power	kW	1,10
GAS HEATING		
Evaporation capacity (gas model)	L/h	65,8
	US gallon/h	17,38
Hourly output (gas model)	Kg/h	128,60
	lb/h	283,51
Installed gas heating power	kcal/h	77386
	Btu/h	307093
Installed gas heating power	kW	90
Installed electrical power	kW	2,25
Instant propane gas consumption (G31)	Kg/h	7,71
	lb/h	17
Instant natural gas consumption (G20)	m ³ /h	9,53
	cfm	5,61
Ø Gas inlet	BSPP ISO 228-1	3/4"
STEAM HEATING		
Installed steam heating power	kW	128
	Btu/h	436754
Installed electrical power	kW	2,25
Steam consumption (8 barG) - Standard	kg/h	171
Steam consumption (116 psiG)	lb/h	206
Steam pressure	barG	7 - 12
	psiG	101,5 - 174
Standard steam inlet - outlet	BSPT- ISO7.1	1"
Steam inlet - condensate outlet	NPT ANSI B1.20.1 Tapered	1"
Steam consumption (5 barG) - Low Pressure	kg/h	147
Steam consumption (72,5 psiG) - Low Pressure	lb/h	177,1
Steam pressure (low pressure)	barG	4 - 7
	psiG	58 - 101,5
Low pressure steam inlet - outlet	BSPT- ISO7.1	1" 1/2
VENTILATION		
Fan motor power	kW	1,10
Nominal air flow rate	m ³ /h	3.000
	cfm	1766



Ø Fume exhaust	mm	300	
	inch	11,81	
HEAT EMISSION			
Maximum total heat emission	kW	6,5	
	Btu/h	22124	
Max. front heat emission	kW	2,9	
	Btu/h	9833	
CONNECTIONS			
Tension 230V - I + N + T	Nº x mm ² / A	E	G / S
Tension 230V - III + T	Nº x mm ² / A	-	-
Tension 400V - III + N + T	Nº x mm ² / A	5 x 50 / 125A	5 x 2,5 / 25A
NET DIMENSIONS / PACKING DIMENSIONS			
Net / gross width	mm	1.270 / 1.330	
	inch	50 / 52,4	
Net / gross depth	mm	1.366 / 1.455	
	inch	53,8 / 57,3	
Net height / gross height (* without heating)	mm	2.380 / 2.200	
	inch	93,7 / 86,6	
Net / gross weight	Kg	529 / 575	
	lb	1.166 / 1.268	
OTHERS			
Sound level	dB	67	

* Sizes Gas or steam 45 kg model same as model 80 kg (incorporates the batteries at the back)

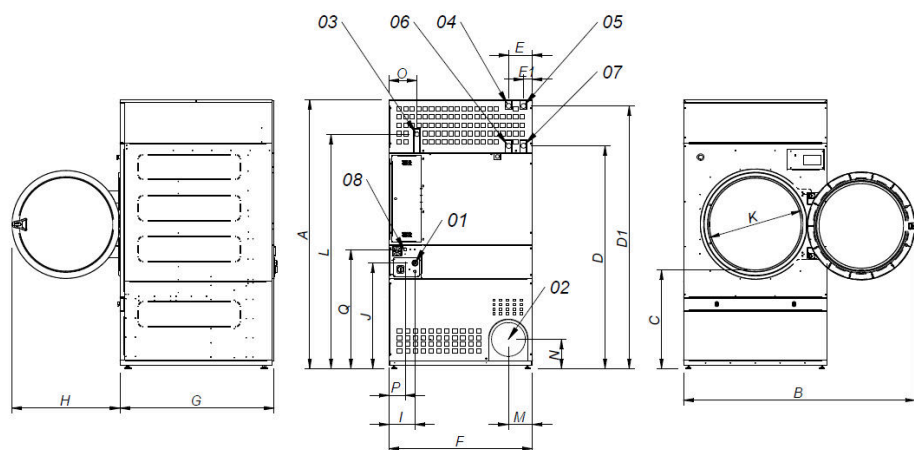

- 01 ELECTRIC CONNECTION
- 02 FUMES OUTLET Ø300
- 03 GAS CONNECTION 3/4"
- 04 STEAM CONNECTION (DD-45) 1"
- 05 STEAM CONNECTION (DD-60/80) 1"
- 06 CONDENSATION OUTLET (DD-45) 1"
- 07 CONDENSATION OUTLET (DD-60/80) 1"
- 08 ETHERNET CONNECTION (only available with ET2 models)

	A	B	C	D	D1	E	E1	F	G	H	I	J	K	L	M	N	O	P	Q
DD-45	2380*	2045	874	1981	2311	211	80	1270	1106	956	248	935	802	2088	214	240	244	160	1053
DD-60	2380*	2045	874	1981	2311	211	80	1270	1366	956	248	935	802	2088	214	240	244	160	1053
DD-80	2380*	2045	874	1981	2311	211	80	1270	1598	956	248	935	802	2088	214	240	244	160	1053

* Measurement with legs mounted (30mm)

