

# DD-18 BASIC EM BASIC dryers



## ELECTRONIC CONTROL

Easy-to-use electronic control with push buttons to control temperature and time



## FEATURES

Reversing drum action as standard  
Galvanized drum as standard  
Frequency inverter as standard



## EFFICIENCY

Big fluff filter



## VERSATILITY

Make to order - customisation  
OPL > Multivending - Standard OPL model easily trasformable to coin laundry uses



## ERGONOMICS

Big door diameters  
Opening sense of door adjustable on site



## MAINTENANCE

Hinged control panel: easy and ergonomic access  
Technical menu: statistics, data recovery for after-sales service, software updates, etc.  
Easy access to components



## OTHERS

White painted panels  
**COOL DOWN** - anti-wrinkle at the end of the cycle  
Electric or gas heating  
CE approved



## OPTIONS

- RD Opposite door opening 11-35
- AF Back panel with air filter from 11 to 35
- BMS New display for EM programmer 11-35
- NG Natural gas heated tumble dryer (LPG as standard)
- 400V 3N 60 Hz DD-11-35
- 230V 3~ 50 Hz DD-11,18 E
- 230V 3~ 60 Hz DD-11,18 E
- 230V 3~ 60 Hz DD-11,35 G/S
- 440/480V 3~ 60 Hz DD-11,18
- Several payment systems for self-service

CAPACITY & DRUM		UNIT.	DD-18 BASIC EM	
Capacity 1/18		Kg	18,3	
		lb	40,4	
Capacity 1/20		Kg	16,5	
		lb	36,3	
Ø Drum		mm	750	
		inch	29,5	
Drum length		mm	746	
		inch	29,4	
Drum volume		l	330	
		cu ft	11,64	
Ø Door hole		mm	574	
		inch	22,6	
Door center height		mm	976	
		inch	38,4	
Height from floor to bottom of door		mm	618	
		inch	24,33	
ELECTRIC HEATING				
Evaporation capacity		L/h	14,1	
		US gallon/h	3,72	
Hourly output		Kg/h	28,3	
		lb/h	62,39	
Installed heating power		kW	18	
Installed electrical power		kW	18,67	
Drum motor power		kW	0,37	
GAS HEATING				
Evaporation capacity (gas model)		L/h	16,30	
		US gallon/h	4,31	
Hourly output (gas model)		Kg/h	31,90	
		lb/h	70,33	
Installed gas heating power		kcal/h	17727	
		Btu/h	69996	
Installed gas heating power		kW	20,5	
Installed electrical power		kW	0,67	
Instant propane gas consumption (G31)		Kg/h	1,76	
		lb/h	3,88	
Instant natural gas consumption (G20)		m <sup>3</sup> /h	2,17	
		cfm	1,28	
Ø Gas inlet		BSPP ISO 228-1	1/2"	
VENTILATION				
Fan motor power		kW	0,25	
Nominal air flow rate		m <sup>3</sup> /h	850	
		cfm	500	
Ø Fume exhaust		mm	200	
		inch	7,87	
HEAT EMISSION				
Maximum total heat emission		kW	1,8	
		Btu/h	6145	
Max. front heat emission		kW	1,3	
		Btu/h	4302	
CONNECTIONS			E	G
Tension 230V - I + N + T		Nº x mm <sup>2</sup> / A	-	3 x 1,5 / 16A
Tension 230V - III + T		Nº x mm <sup>2</sup> / A	4 x 16 / 63A	3 x 1,5 / 16A
Tension 400V - III + N + T		Nº x mm <sup>2</sup> / A	5 x 10 / 32A	3 x 1,5 / 16A
NET DIMENSIONS / PACKING DIMENSIONS				
Net / gross width		mm	785 / 865	
		inch	30,9 / 34,1	



Net / gross depth	mm	1.125 / 1.210
	inch	44,3 / 47,6
Net height / gross height	mm	1.694 / 1.840
	inch	66,7 / 72,4
Net / gross weight	Kg	187 / 200
	lb	412 / 441
<b>OTHERS</b>		
Sound level	dB	64

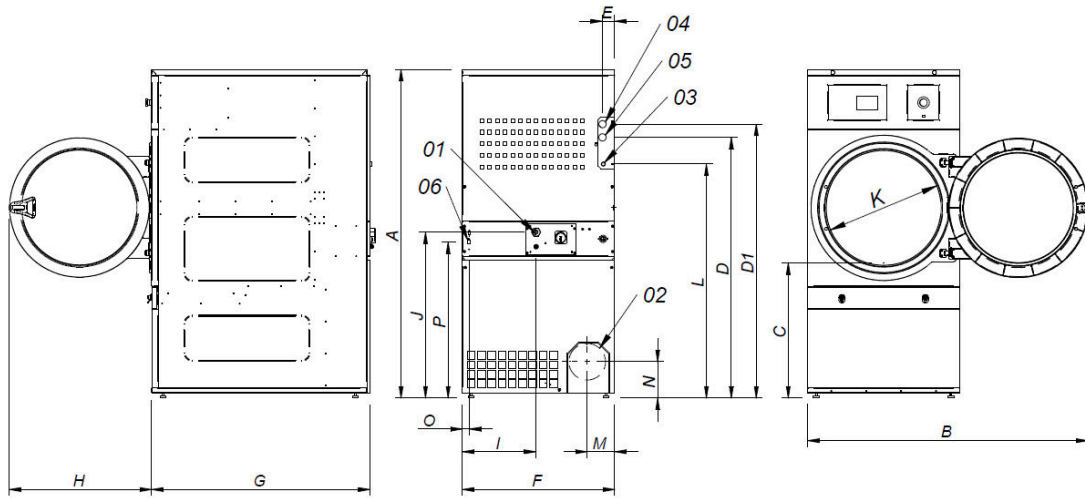

- 01 POWER SUPPLY
- 02 FUMES OUTPUT Ø200
- 03 GAS INLET 1/2"
- 04 STEAM INLET 3/4" (DD-18)
- 04 STEAM INLET 1" (DD-22)
- 05 CONDENSATE OUTLET 3/4" (DD-18)
- 05 CONDENSATE OUTLET 1" (DD-22)
- 06 ETHERNET CONNECTION (only available CONTROL ET2 models)

	A	B	C	D	D1	E	E1	F	G	H	I	J	K	L	M	N	O	P
DD-18	1694*	1447	689	1354	1422	68	68	785	1125	735	380	870	575	1226	133	180	35	805
DD-22	1812*	1552	743	1430	1532	112	55	890	1255	735	107	920	575	1344	238	180	37	860

\* Measurement with legs mounted (30mm)

