

DD-22 SILVER ET2 SILVER dryers



EASY TOUCH 2

User friendly and totally programmable 7" ET2
USB Connection.
Online platform free of charge for programming, telemetry, data analysis
Videos on display (ads, instructions, etc.)
37 languages



FEATURES

Reversing drum action as standard
Stainless steel drum as standard
Frequency inverter as standard



EFFICIENCY

DOUBLE FLOW - mixed axial-radial airflow
Big fluff filter as drawer



VERSATILITY

Make to order - customisation
WET CLEANING
OPL > Multivending - Standard OPL model easily trasformable to coin laundry uses



CONNECTIVITY

Danube Online communication - IoT as standard
Remote technical service
Management of laundries: OPL and COIN



ERGONOMICS

Drawer as fluff filter, stainless steel mesh
Big door diameters
Opening sense of door adjustable on site



MAINTENANCE

Hinged control panel: easy and ergonomic access
Technical menu: statistics, data recovery for after-sales service, software updates, etc.
Easy access to components



OTHERS

Grey skinplate outer casing, stainless steel look
NEW: transmission by gear motor on models DD-45 to 80
SOFT DRY - new drum with stamped holes
COOL DOWN - anti-wrinkle at the end of the cycle
Electric, gas or steam heating
CE approved



OPTIONS

- IoT licence - Danube Online
- NG Natural gas heated tumble dryer (LPG as standard)
- IMC CARE DRY Humidity sensor
- DG Double doorglass DD-11-28
- FEX Sprinkler fire extinguisher 22,28
- RD Opposite door opening 11-35
- TR Tropicalized model (ET2)
- DS Perfumes dosing / spraying
- AF Back panel with air filter from 11 to 35
- F06 Fluff filter with grid 0,6mm (standard is 0,3mm)
- F12 Fluff filter with grid 1,2 mm (standard is 0,3 mm)
- SSC Stainless steel outer casing 22
- LPB Low steam pressure battery 22
- SSF Stainless steel front panel 22
- BSS Stainless steel steam battery 22
- LPB Low steam pressure battery 22
- WB Wooden packing 22
- 400V 3N 60 Hz DD-11-35
- 230V 3~ 50 Hz DD-22-35 E
- 230V 3~ 60 Hz DD-22,35 E
- 230V 3~ 60 Hz DD-11,35 G/S
- 440/480V 3~ 60 Hz DD-22-35
- Several payment systems for self-service

CAPACITY & DRUM	UNIT.	DD-22 SILVER ET2
Capacity 1/18	Kg	24,4
	lb	53,9
Capacity 1/20	Kg	22
	lb	48,5
Ø Drum	mm	835
	inch	32,87
Drum length	mm	800
	inch	31,5
Drum volume	l	440
	cu ft	15,54
Ø Door hole	mm	574
	inch	22,60
Door center height	mm	1.030
	inch	40,55
Height from floor to bottom of door	mm	672
	inch	26,46
ELECTRIC HEATING		
Evaporation capacity	L/h	17
	US gallon/h	4,5
Hourly output	Kg/h	34
	lb/h	75
Installed heating power	kW	24
Installed electrical power	kW	24,97
Drum motor power	kW	0,37
GAS HEATING		
Evaporation capacity (gas model)	L/h	20
	US gallon/h	5,283
Hourly output (gas model)	Kg/h	40
	lb/h	88,2
Installed gas heating power	kcal/h	26655
	Btu/h	105775,6
Installed gas heating power	kW	31
Installed electrical power	kW	0,97
Instant propane gas consumption (G31)	Kg/h	2,66
	lb/h	5,86
Instant natural gas consumption (G20)	m ³ /h	3,28
	cfm	1,93
Ø Gas inlet	BSPP ISO 228-1	1/2"
STEAM HEATING		
Installed steam heating power	kW	49,20
	Btu/h	167877
Installed electrical power	kW	0,97
Steam consumption (8 barG) - Standard	kg/h	87
Steam consumption (116 psiG)	lb/h	104,8
Steam pressure	barG	6 - 9
	psiG	87 - 130,5
Standard steam inlet - outlet	BSPT- ISO7.1	1"
Steam inlet - condensate outlet	NPT ANSI B1.20.1 Tapered	1"
Steam pressure (low pressure)	barG	3 - 6
	psiG	43,5 - 93
Low pressure steam inlet - outlet	BSPT- ISO7.1	1"
VENTILATION		
Fan motor power	kW	0,55
Nominal air flow rate	m ³ /h	1.200
	cfm	706,29
Ø Fume exhaust	mm	200
	inch	7,87



HEAT EMISSION			
Maximum total heat emission	kW	2,4	
	Btu/h	8193,9	
Max. front heat emission	kW	1,68	
	Btu/h	5735,8	
CONNECTIONS		E	G / S
Tension 230V - I + N + T	Nº x mm ² / A	-	3 x 1,5 / 16A
Tension 230V - III + T	Nº x mm ² / A	4 x 25 / 80A	3 x 1,5 / 16A
Tension 400V - III + N + T	Nº x mm ² / A	5 x 10 / 40A	3 x 1,5 / 16A
NET DIMENSIONS / PACKING DIMENSIONS			
Net / gross width	mm	890 / 970	
	inch	35,04 / 38,19	
Net / gross depth	mm	1.255 / 1.345	
	inch	49,41 / 52,95	
Net height / gross height (* without heating)	mm	1.812 / 1.940	
	inch	71,34 / 76,38	
Net / gross weight	Kg	210 / 230	
	lb	462,97 / 507,06	
OTHERS			
Sound level	dB	65	

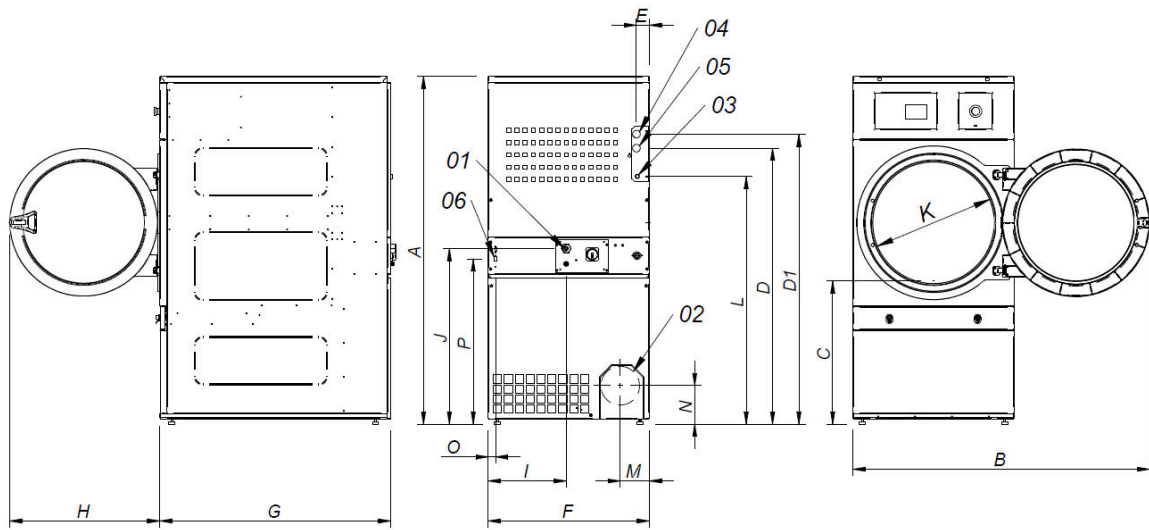

- 01 POWER SUPPLY
- 02 FUMES OUTPUT Ø200
- 03 GAS INLET 1/2"
- 04 STEAM INLET 3/4" (18kg)
- 04 STEAM INLET 1" (22 kg)
- 05 CONDENSATE OUTLET 3/4" (18kg)
- 05 CONDENSATE OUTLET 1" (22 kg)
- 06 ETHERNET CONNECTION

	A	B	C	D	D1	E	E1	F	G	H	I	J	K	L	M	N	O	P
DD-18	1694*	1447	689	1354	1422	68	68	785	1125	735	380	870	575	1226	133	180	35	805
DD-22	1812*	1552	743	1430	1532	112	55	890	1255	735	107	920	575	1344	238	180	37	860

* Measurement with legs mounted (30mm)

