

DD-14 BASIC EM BASIC dryers



ELECTRONIC CONTROL

Easy-to-use electronic control with push buttons to control temperature and time



FEATURES

Reversing drum action as standard
Galvanized drum as standard
Frequency inverter as standard



EFFICIENCY

Big fluff filter



VERSATILITY

Make to order - customisation
OPL > Multivending - Standard OPL model easily trasformable to coin laundry uses



ERGONOMICS

Big door diameters
Opening sense of door adjustable on site



MAINTENANCE

Hinged control panel: easy and ergonomic access
Technical menu: statistics, data recovery for after-sales service, software updates, etc.
Easy access to components



OTHERS

White painted panels
COOL DOWN - anti-wrinkle at the end of the cycle
Electric or gas heating
CE approved



OPTIONS

- RD Opposite door opening 11-35
- AF Back panel with air filter from 11 to 35
- BMS New display for EM programmer 11-35
- NG Natural gas heated tumble dryer (LPG as standard)
- RP Reduced power (12kw instead of 18kw) for electric heated 14kg and 18kg models.
- 400V 3N 60 Hz DD-11-35
- 230V 3~ 50 Hz DD-11,18 E
- 230V 3~ 60 Hz DD-11,18 E
- 230V 3~ 60 Hz DD-11,35 G/S
- 440/480V 3~ 60 Hz DD-11,18
- Several payment systems for self-service

CAPACITY & DRUM		UNIT.	DD-14 BASIC EM	
Capacity 1/18		Kg	15	
		lb	33,1	
Capacity 1/20		Kg	13,5	
		lb	29,8	
Ø Drum		mm	750	
		inch	29,5	
Drum length		mm	610	
		inch	24	
Drum volume		l	270	
		cu ft	9,53	
Ø Door hole		mm	574	
		inch	22,6	
Door center height		mm	976	
		inch	38,4	
Height from floor to bottom of door		mm	618	
		inch	24,33	
ELECTRIC HEATING				
Evaporation capacity		L/h	13,5	
		US gallon/h	3,57	
Hourly output		Kg/h	26,9	
		lb/h	59,30	
Installed heating power		kW	18	
Installed electrical power		kW	18,67	
Drum motor power		kW	0,37	
GAS HEATING				
Evaporation capacity (gas model)		L/h	15,4	
		US gallon/h	4,07	
Hourly output (gas model)		Kg/h	30,25	
		lb/h	66,69	
Installed gas heating power		kcal/h	17727	
		Btu/h	69996	
Installed gas heating power		kW	20,5	
Installed electrical power		kW	0,67	
Instant propane gas consumption (G31)		Kg/h	1,76	
		lb/h	3,88	
Instant natural gas consumption (G20)		m ³ /h	2,17	
		cfm	1,28	
Ø Gas inlet		BSPP ISO 228-1	1/2"	
VENTILATION				
Fan motor power		kW	0,25	
Nominal air flow rate		m ³ /h	850	
		cfm	500	
Ø Fume exhaust		mm	200	
		inch	7,87	
HEAT EMISSION				
Maximum total heat emission		kW	1,8	
		Btu/h	6145	
Max. front heat emission		kW	1,3	
		Btu/h	4302	
CONNECTIONS			E	G
Tension 230V - I + N + T		Nº x mm ² / A	-	3 x 1,5 / 16A
Tension 230V - III + T		Nº x mm ² / A	4 x 16 / 63A	3 x 1,5 / 16A
Tension 400V - III + N + T		Nº x mm ² / A	5 x 10 / 32A	3 x 1,5 / 16A
NET DIMENSIONS / PACKING DIMENSIONS				
Net / gross width		mm	785 / 865	
		inch	30,9 / 34,1	



Net / gross depth	mm	989 / 1.074
	inch	38,9 / 42,3
Net height / gross height	mm	1.694 / 1.840
	inch	66,7 / 72,4
Net / gross weight	Kg	180 / 190
	lb	397 / 419
OTHERS		
Sound level	dB	64

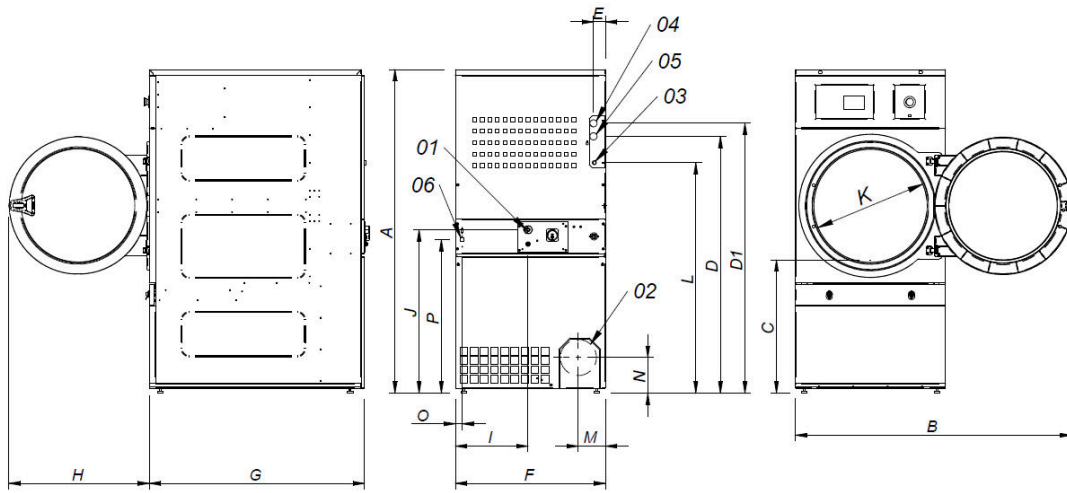

- 01 POWER SUPPLY
- 02 FUMES OUTPUT Ø200
- 03 GAS INLET 1/2"
- 04 STEAM INLET 3/4"
- 05 CONDENSATE OUTLET 3/4"
- 06 ETHERNET CONNECTION (only available CONTROL ET2 models)

	A	B	C	D	D1	E	E1	F	G	H	I	J	K	L	M	N	O	P
DD-11	1694*	1447	689	1354	1422	68	68	785	855	735	380	870	575	1226	133	180	35	805
DD-14	1694*	1447	689	1354	1422	68	68	785	989	735	380	870	575	1226	133	180	35	805

* Measurement with legs mounted (30mm)

